

**APPLICATION FOR ZONING PERMIT
VILLAGE OF CALDWELL, OHIO
ZONING CLASSIFICATION _____**

APPLICANT'S NAME _____ PHONE # _____

APPLICANT'S ADDRESS _____

PROPERTY OWNER: _____ PHONE # _____

CONTRACTOR'S NAME _____

ADDRESS TO BE ZONED _____

CURRENT USE OF PROPERTY _____

PROPOSED USE (check all that apply):

- | | |
|---|---|
| <input type="checkbox"/> New single family dwelling | <input type="checkbox"/> Room addition(s) |
| <input type="checkbox"/> New duplex | <input type="checkbox"/> Carport/garage |
| <input type="checkbox"/> New apartments/# units _____ | <input type="checkbox"/> Porch/deck |
| <input type="checkbox"/> New commercial building | (Covered ___ Uncovered ___) |
| <input type="checkbox"/> New industrial building | <input type="checkbox"/> Home occupation |
| <input type="checkbox"/> Accessory structures: | <input type="checkbox"/> Signs (s) (total sq. ft. _____). |
| <input type="checkbox"/> Storage building | <input type="checkbox"/> Existing commercial building |
| <input type="checkbox"/> Swimming pool | (Change of use/ownership) |
| <input type="checkbox"/> Fence/wall ___ Height | <input type="checkbox"/> Other _____ |

Building/addition Dimensions _____ Sq. Ft. _____ Height to Peak _____

Business Name _____

Type and size of sign(s) _____

Parking--Existing spaces _____ Proposed spaces _____

The undersigned is hereby applying for a zoning permit for the above use, said permit to be issued on the basis of information contained within this application. The applicant hereby certifies that all information and attachments to this application are true and correct.

Applicant's signature

Date of application

PLOT PLAN

P M _____
LOT NO _____
PARCEL/FC _____

NAME: _____
ADDRESS: _____

The applicant is required to submit with this application for a Zoning Permit, a Plot Plan showing the actual size and dimension of the lot, exact sizes and locations of existing buildings, the location and dimensions of the proposed buildings, alterations or room additions, and the measurements of the rear, front and side yards. In addition, the dimensions and location of any supplemental requirements, including parking spaces provided and sign size and location are to be shown. Please indicate street, street address and alleys bordering the project site.

All Zoning Applicants need to call the Ohio Utilities Protection Service at 1-800-362-2764 before starting to dig.

SAMPLE PLOT PLAN

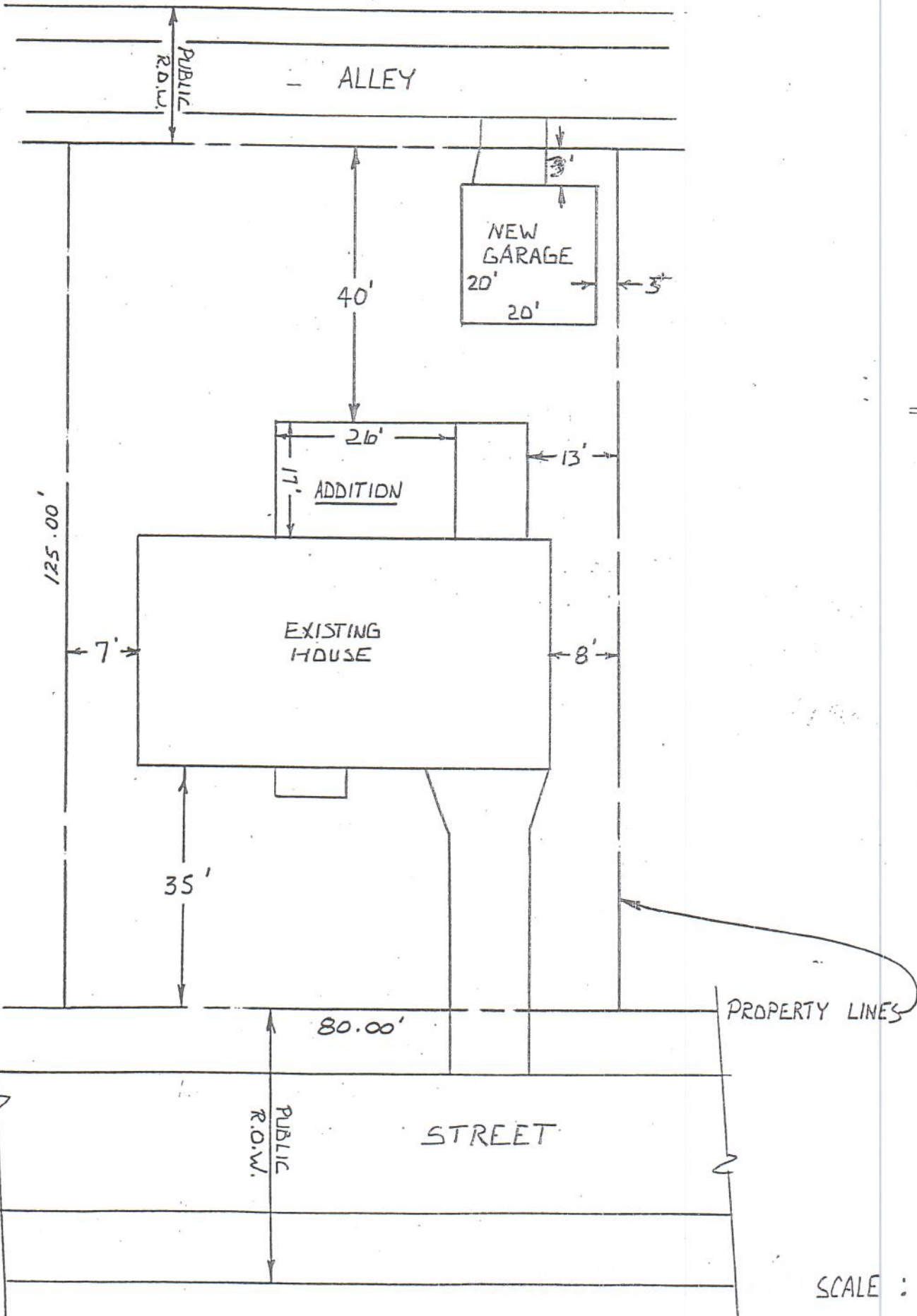

SCALE : 1" = 20'

VILLAGE OF CALDWELL

215 WEST STREET
CALDWELL, OHIO 43724

Section 25.03 Residential Fences and /or Hedges

"Fence or Wall " means any structure composed of wood, metal, stone, brick or other material, including hedges or other plants, erected in such a manner and location so as to enclose, partially enclose or divide any premises or part of premises for the purpose of confinement, screening, partitioning, or decoration. Trellises or other structures for the purpose of supporting vines, flowers or other vegetation, when erected in such a position so as to enclose, partially enclose or divide any premises or any part of premises shall also be considered a fence. A "decorative fence" means a fence that is not suited for the containment of animals or property, in which the opacity of the fence is less than twenty-five percent (25%).

No fence or wall, as defined above may be erected in the Village of Caldwell unless the property owner or his agent files application with the Zoning Inspector. Such application shall include a drawing of the lot, showing the actual location of the proposed fence or wall. The property owner shall determine property lines and certify that the fence or wall does not encroach upon another lot or parcel of land. The granting of a permit to construct a fence in no way shall be considered as the Villages authorization that the property lines as shown on the application are correct.

A. Height and Location

The permitted height of a fence or wall shall be determined by its location on the property as follows:

1. A decorative fence or wall not exceeding 48 inches in height may be erected within the front yard provided that the fence or hedge is located not less than three (3) feet from the street right of way line, and further provided that the provisions of 25.03.A.03 below are met.
2. A fence or wall not exceeding seventy-two inches (72") in height may be erected in any area of the lot behind the building setback line.
3. No fence, edge, or wall shall be erected on any lot in such a manner so as to obscure the vision of motorists approaching a street intersection, within a twenty-five (25) feet clear sight distance along either street approaching said intersection.

B. Prohibited Fences

1. *Electrafied or charged fences*
2. *Barbed wire fences*